

FLK 费洛卡重工



QZ 系列钢绳葫芦升降驱动系统
QZ Series Wire Rope Hoist Lifting Drive Syestem



产品目录 PRODUCT CATALOG

QZ3201钢绳葫芦升降驱动系统..... 05
QZ3201 Wire Rope Hoist Lifting Drive System

QZ5000钢绳葫芦升降驱动系统..... 07
QZ5000 Wire Rope Hoist Lifting Drive System

QZ12500钢绳葫芦升降驱动系统.....09
QZ12500 Wire Rope Hoist Lifting Drive System

QZ20000钢绳葫芦升降驱动系统.....11
QZ20000 Wire Rope Hoist Lifting Drive System

QZ25000钢绳葫芦升降驱动系统.....13
QZ25000 Wire Rope Hoist Lifting Drive System

QZ40000钢绳葫芦升降驱动系统.....15
QZ40000 Wire Rope Hoist Lifting Drive System

费洛卡升降电机

费洛卡升降电机有多种规格，可支持功率范围为0.37~24.2kW。

具有以下突出特征：

- 强劲的马力和良好的冷却特性
- 集成式双面安全制动，响应快、低磨损，噪音低
- 电机绝缘等级H级，寿命更长久

费洛卡升降驱动系统

费洛卡升降系统系列配有6种尺寸直接驱动钢绳卷筒并带制动齿轮电机。该驱动系统的设计基于FEM分析可实现4/1的滑轮倍率承载2到40吨，保证安全而可靠的起升操作。

显著特点有：

- 重量轻，装配简单
- 紧凑而强劲的驱动单元
- 三级平行轴式斜齿轮减速电机，结构紧凑，传动效率高，轴距加长，可安装更大直径卷筒
- 基于EXT标准设计的花键直接安装于卷筒，U型底座结构，安装简单，节省空间
- 起升速度，4/5/6.3和8m/min(4/1的滑轮倍率)
- 产品奉命周期内免维护

制动器

起重和升降驱动系统都设计配有双面安全制动器从而具有以下优势：

- 性能可靠，响应速度快
- 磨损小，寿命长
- 双面失电制动
- 安全且无振动的制动
- 非石棉的制动片

FLK Hoisting Electric Motor

FLK hoisting electric motor power ranges from 0.37~24.2KW

Features:

- Higher power and highly efficient motor cooling
- Intergrated double side safety brake, quick response, low weak, low noise
- Motor insulation grade H, long life service

FLK Hoisting Drive System

FLK hoisting drive system is available with 6 size designs which can drive the wire rope drum directly and FEM based design realizes 4/1 pulley ratio with load capacity from 2-40T, which ensures the lifting safely and reliability.

Features:

- Light weight, easy assembly
- Compact and strong drive unit
- 3 stage parallel shaft helical geared motor, compact construction, high efficiency, long extended center distance, allowing bigger drum mounted
- EXT standard based design, spline mounting directly to drum, U shape base, simple mounting, low space
- Lifting speed, 4/5/6.3 and 8m/min(4/1 pulley ratio, double speed or frequency)
- Free maintenance within life period

Brake

Hoisting and lifting drive system are designed with double side safety brake with follow features:

- Reliable performance, quick response
- Low wear, long life service
- Double side electric loss brake
- Safe and nonvibration brake
- Non asbestos brake pads

QZ3201 钢绳葫芦升降驱动系统

QZ3201 Wire Rope Hoist Lifting Drive System

产品描述 Description

- 参照FEM标准设计的结构紧凑的钢绳葫芦升降驱动系统
- 三级平行轴式齿轮减速电机，直接安装于卷筒
- 带双面安全制动器的大功率升降电机
- 通过标准接口装配简单
- Compact construction and in accordance with FEM
- 3 stage Parallel Shaft Geared Motor, directly mounted in hoisting drum
- High power hoisting electric motor with double side safety brake
- Standard connector, simple to install

技术数据 Technical Data

技术数据 Technical Data	
起升重量 Lifting capacity	达到3.2吨 up to 3.2T
起升速度 Lifting speed	4/5/6. 3/7. 5m/min 4/1的滑轮倍率 4/5/6. 3/7. 5m/min 4/1pulley ratio
卷筒直径 Drum Diameter	140mm
电机功率 Motor power	P=0.44/3.0-0.72/4.8kW (12/2极数) P=0.44/3.0-0.72/4.8kW (12/2poles)
输出轴EXT Output shaft EXT	EXT W38X2X30X18X6h

产品优势

- 重量轻-运输成本低，装配简单
- 效率高-节能
- 设计紧凑-节省空间
- 轴距长-方便安装
- 动态的加速特性-较大的启动和极限力矩
- 双面安全制动-安全且无振动的制动
- 卷筒轴承支持与升降驱动系统集成设计

Advantages

- Low weight -low shipping cost, simple to install
- Highly efficient-energy saving
- Compact design- space-saving
- Long center distance-mounting friendly
- Dynamic acceleration characteristics-heavier starting and limited torque
- Double side safety brake-safety and vibration free
- Integrated design is applied in drum bearing support and lifting drive system

QZ3201 钢绳葫芦升降驱动系统 QZ3201 Wire Rope Hoist Lifting Drive System

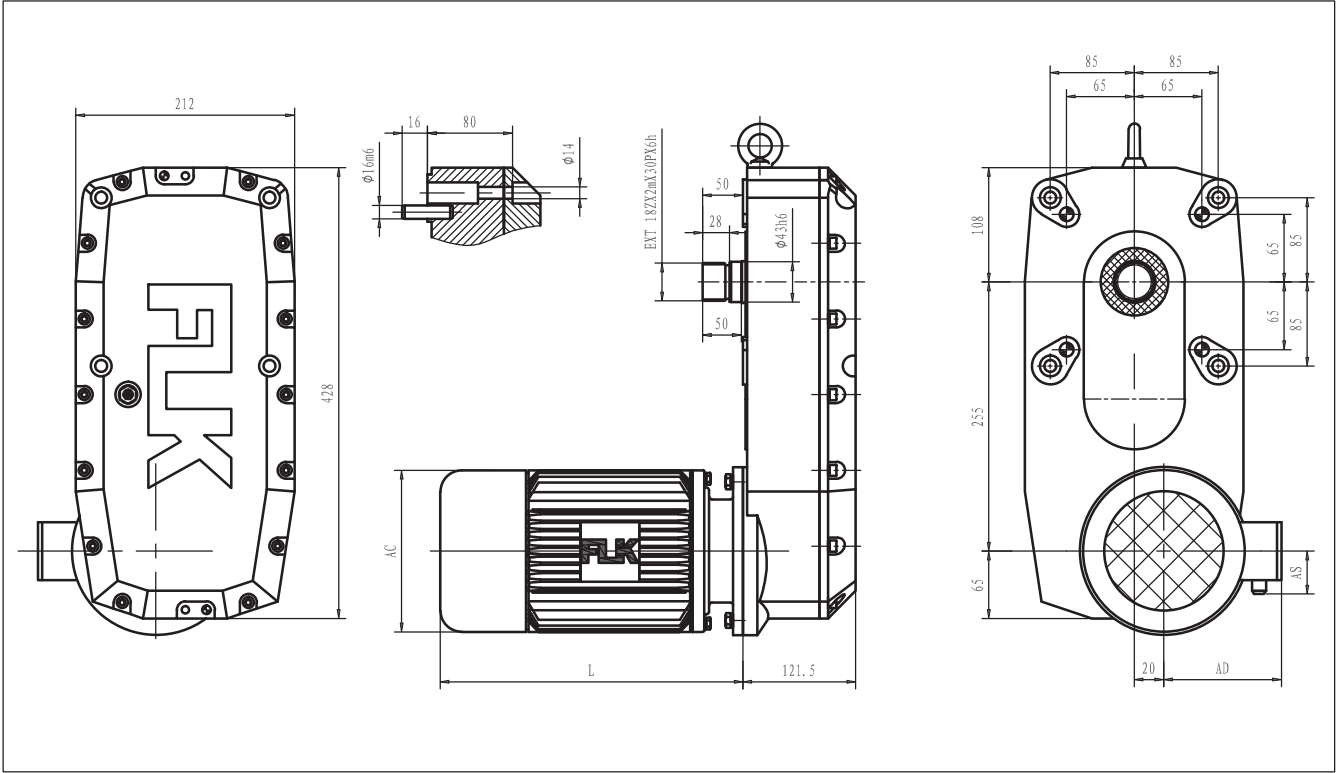

QZ3201 升降驱动系统技术数据						QZ3201 Wire Rope Hoist Lifting Drive System					
卷筒直径 140mm				4/1的滑轮倍率		Drum Diameter140mm				4/1pulley ratio	
Pos.	Load [t]	ISO	FEM	V [m/min]	P [kW]	f [Hz]	减 速 比 Ratio [i]	制动力矩 Brake Torque [N · m]	型 号 Type	电机尺寸 Motor Size [mm]	
1	3.2	M5	2m	0.66/4.0 (0.8/4.8)	0.44/3.0 (0.528/3.6)	50 (60)	76.6	60	QZ3201-76.6-0.44/3.0-12/2	L:	475
	2.5	M6	3m							AC:	218
	2	M7	4m							AD:	190
										AS:	71
2	3.2	M5	2m	0.8/5.0 (1.0/6.0)	0.54/3.8 (0.648/4.56)	50 (60)	63.4	60	QZ3201-63.4-0.54/3.8-12/2	L:	475
	2.5	M6	3m							AC:	218
	2	M7	4m							AD:	190
										AS:	71
3	3.2	M5	2m	1.0/6.3 (1.2/7.6)	0.72/4.8 (0.864/5.76)	50 (60)	51.1	60	QZ3201-51.1-0.72/4.8-12/2	L:	500
	2.5	M6	3m							AC:	218
	2	M7	4m							AD:	190
										AS:	71
4	2.5	M5	2m	1.3/7.5 (1.6/9.0)	0.72/4.8 (0.864/5.76)	50 (60)	41.7	60	QZ3201-41.7-0.72/4.8-12/2	L:	500
	2	M6	3m							AC:	218
	1.6	M7	4m							AD:	190
										AS:	71

QZ5000 钢绳葫芦升降驱动系统

QZ5000 Wire Rope Hoist Lifting Drive System

产品描述 Description

- 参照FEM标准设计的结构紧凑的钢绳葫芦升降驱动系统
- 三级平行轴式齿轮减速电机，直接安装于卷筒
- 带双面安全制动器的大功率升降电机
- 通过标准接口装配简单
- Compact construction and in accordance with FEM
- 3 stage Parallel Shaft Geared Motor, directly mounted in hoisting drum
- High power hoisting electric motor with double side safety brake
- Standard connector, simple to install

技术数据 Technical Data

技术数据 Technical Data	
起升重量 Lifting capacity	达到6.8吨 up to 6.8T
起升速度 Lifting speed	4/5/6.3/8m/min 4/1的滑轮倍率 4/5/6.3/8m/min 4/1pulley ratio
卷筒直径 Drum Diameter	170mm
电机功率 Motor power	P=1.0/5.9-1.9/11.8kW (12/2极数) P=1.0/5.9-1.9/11.8kW (12/2poles)
输出轴EXT Output shaft EXT	EXT W44X2X30X21X6h

产品优势

- 重量轻-运输成本低，装配简单
- 效率高-节能
- 设计紧凑-节省空间
- 轴距长-方便安装
- 动态的加速特性-较大的启动和极限力矩
- 双面安全制动-安全且无振动的制动
- 卷筒轴承支持与升降驱动系统集成设计

Advantages

- Low weight -low shipping cost, simple to install
- Highly efficient-energy saving
- Compact design- space-saving
- Long center distance-mounting friendly
- Dynamic acceleration characteristics-heavier starting and limited torque
- Double side safety brake-safety and vibration free
- Integrated design is applied in drum bearing support and lifting drive system

QZ5000 钢绳葫芦升降驱动系统

QZ5000 Wire Rope Hoist Lifting Drive System

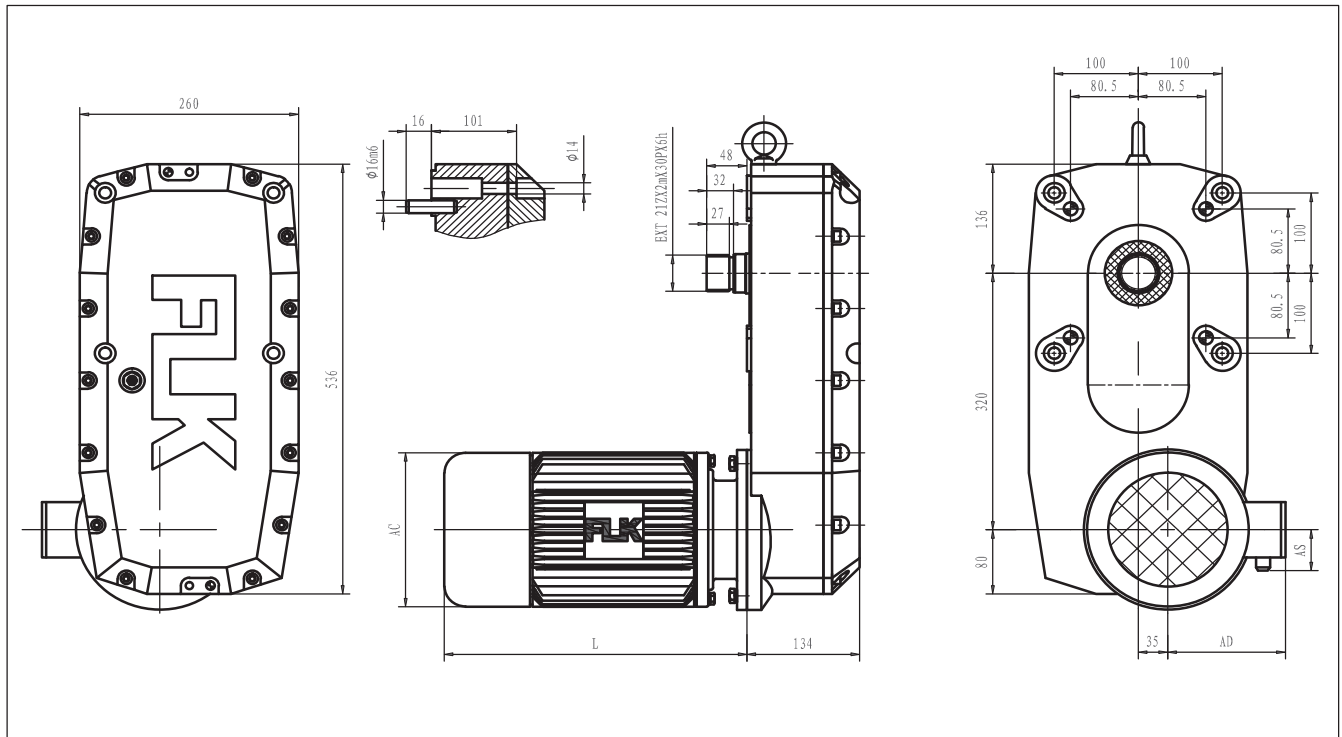

QZ5000 升降驱动系统技术数据							QZ5000 Wire Rope Hoist Lifting Drive System			
卷筒直径 170mm 4/1的滑轮倍率							Drum Diameter 170mm 4/1 pulley ratio			
Pos.	Load [t]	ISO	FEM	V [m/min]	P [kW]	f [Hz]	减速比 Ratio [i]	制动力矩 Brake Torque [N · m]	型号 Type	电机尺寸 Motor Size [mm]
1	6.8	M5	2m	0.66/4.0 (0.8/4.8)	1.0/5.9 (1.2/7.08)	50 (60)	91.1	60	QZ5000-85.8-1.0/5.9-12/2	L: 560 AC: 227 AD: 190 AS: 71
2	6.8	M5	2m	0.8/5.0 (1.0/6.0)	1.2/7.3 (1.44/8.76)	50 (60)	74.8	60	QZ5000-78.3-1.2/7.3-12/2	L: 560 AC: 227 AD: 190 AS: 71
3	6.8	M4	1Am	1.0/6.3 (1.2/7.6)	1.6/9.2 (1.92/11.04)	50 (60)	59.5	100	QZ5000-64.1-1.6/9.2-12/2	L: 610 AC: 279 AD: 210 AS: 75
4	6.8	M4	1Am	1.3/7.5 (1.6/9.0)	1.9/11.8 (2.28/14.16)	50 (60)	49.0	100	QZ5000-52.5-1.9/11.8-12/2	L: 610 AC: 279 AD: 210 AS: 75

QZ12500 钢绳葫芦升降驱动系统

QZ12500 Wire Rope Hoist Lifting Drive System

产品描述 Description

- 参照FEM标准设计的结构紧凑的钢绳葫芦升降驱动系统
- 三级平行轴式齿轮减速电机，直接安装于卷筒
- 带双面安全制动器的大功率升降电机
- 通过标准接口装配简单
- Compact construction and in accordance with FEM
- 3 stage Parallel Shaft Geared Motor, directly mounted in hoisting drum
- High power hoisting electric motor with double side safety brake
- Standard connector, simple to install

技术数据 Technical Data

技术数据 Technical Data	
起升重量 Lifting capacity	达到12.5吨 up to 12.5T
起升速度 Lifting speed	4/5/6.3/8m/min 4/1的滑轮倍率 4/5/6.3/8m/min 4/1pulley ratio
卷筒直径 Drum Diameter	266mm
电机功率 Motor power	P=1.44/9.1-2.4/15.0kW (12/2极数) P=1.44/9.1-2.4/15.0kW (12/2poles)
输出轴EXT Output shaft EXT	EXT W64X2X30X31X6h

产品优势

- 重量轻-运输成本低，装配简单
- 效率高-节能
- 设计紧凑-节省空间
- 轴距长-方便安装
- 动态的加速特性-较大的启动和极限力矩
- 双面安全制动-安全且无振动的制动
- 卷筒轴承支持与升降驱动系统集成设计

Advantages

- Low weight -low shipping cost, simple to install
- Highly efficient-energy saving
- Compact design- space-saving
- Long center distance-mounting friendly
- Dynamic acceleration characteristics-heavier starting and limited torque
- Double side safety brake-safety and vibration free
- Integrated design is applied in drum bearing support and lifting drive system

QZ12500 钢绳葫芦升降驱动系统 QZ12500 Wire Rope Hoist Lifting Drive System

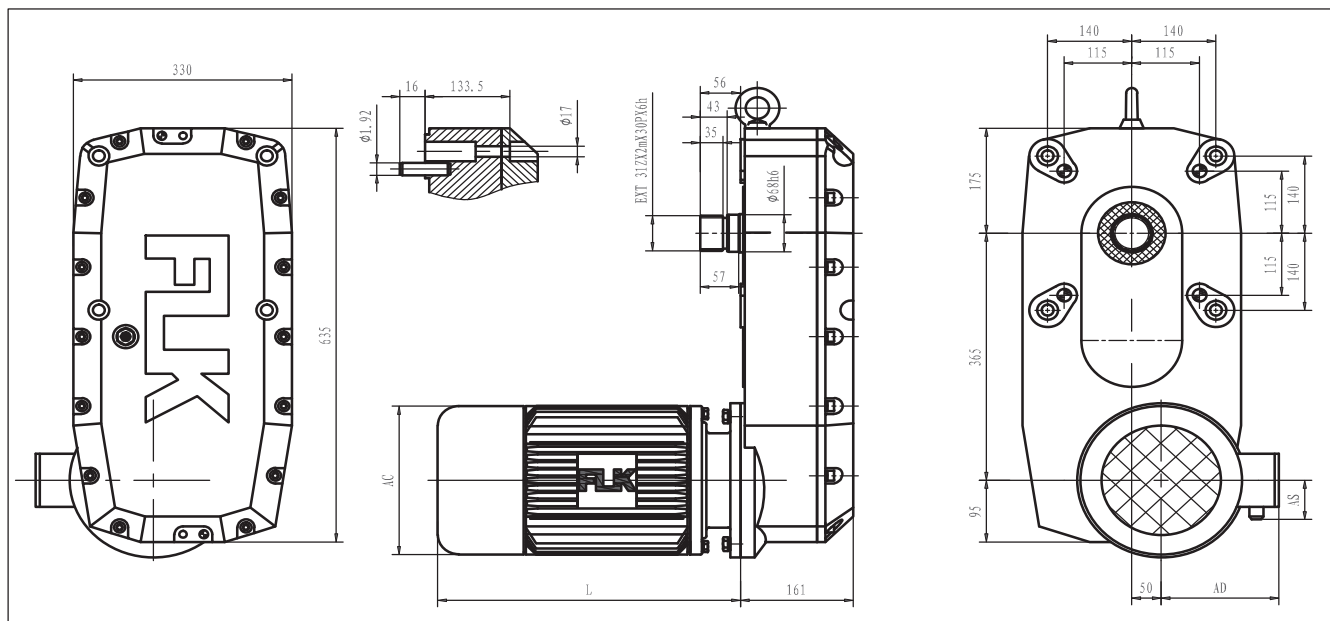

QZ12500 升降驱动系统技术数据

卷筒直径 266mm

4/1的滑轮倍率

QZ12500 Wire Rope Hoist Lifting Drive System

Drum Diameter 266mm

4/1pulley ratio

Pos.	Load [t]	ISO	FEM	V [m/min]	P [kW]	f [Hz]	减 速 比 Ratio [i]	制动力矩 Brake Torque [N · m]	型 号 Type	电机尺寸 Motor Size [mm]
1	10 8 6.3 5	M5 M6 M7 M7	2m 3m 4m 4m	0.66/4.0 (0.8/4.8)	1.44/9.1 (1.728/10.92)	50 (60)	130.2	100	QZ12500-152.1-11.44/9.1-12/2	L: 610 AC: 279 AD: 210 AS: 75
2	10 8 6.3 5	M5 M6 M7 M7	2m 3m 4m 4m	0.8/5.0 (1.0/6.0)	1.8/11.4 (2.16/13.68)	50 (60)	105.7	100	QZ12500-108.9-1.8/11.4-12/2	L: 610 AC: 279 AD: 210 AS: 75
3	8 6.3 5 4	M5 M6 M7 M7	2m 3m 4m 4m	1.0/6.3 (1.2/7.6)	1.8/11.4 (2.16/13.68)	50 (60)	91.3	100	QZ12500-90.6-1.8/11.4-12/2	L: 610 AC: 279 AD: 210 AS: 75
4	6.3 5 4 3.2	M5 M6 M7 M7	2m 3m 4m 4m	1.3/8.0 (1.6/9.6)	1.8/11.4 (2.16/13.68)	50 (60)	71.1	100	QZ12500-72.5-1.8/11.4-12/2	L: 610 AC: 279 AD: 210 AS: 75
5	12.5 10 8 6.3	M5 M6 M7 M7	2m 3m 4m 4m	0.66/4.0 (0.8/4.8)	1.8/11.4 (2.16/13.68)	50 (60)	130.2	100	QZ12500-152.1-1.8/11.4-12/2	L: 610 AC: 279 AD: 210 AS: 75
6	12.5 10 8 6.3	M4 M5 M6 M7	1Am 2m 3m 4m	0.8/5.0 (1.0/6.0)	2.4/15.0 (2.88/18.0)	50 (60)	105.7	150	QZ12500-108.9-2.4/15.0-12/2	L: 655 AC: 279 AD: 210 AS: 75
7	10 8 6.3 5	M4 M5 M6 M7	1Am 2m 3m 4m	1.0/6.3 (1.0/6.0)	2.4/15.0 (2.88/18.0)	50 (60)	91.3	150	QZ12500-90.6-2.4/15.0-12/2	L: 655 AC: 279 AD: 210 AS: 75
8	8 6.3 5 4	M4 M5 M6 M7	1Am 2m 3m 4m	1.3/8.0 (1.6/9.6)	2.4/15.0 (2.88/18.0)	50 (60)	71.1	150	QZ12500-72.5-2.4/15.0-12/2	L: 655 AC: 279 AD: 210 AS: 75

QZ20000 钢绳葫芦升降驱动系统

QZ20000 Wire Rope Hoist Lifting Drive System

产品描述 Description

- 参照FEM标准设计的结构紧凑的钢绳葫芦升降驱动系统
- 三级平行轴式齿轮减速电机，直接安装于卷筒
- 带双面安全制动器的大功率升降电机
- 通过标准接口装配简单
- Compact construction and in accordance with FEM
- 3 stage Parallel Shaft Geared Motor, directly mounted in hoisting drum
- High power hoisting electric motor with double side safety brake
- Standard connector, simple to install

技术数据 Technical Data

技术数据 Technical Data	
起升重量 Lifting capacity	达到20吨 up to 20T
起升速度 Lifting speed	4/5/6. 3/8m/min 4/1的滑轮倍率 4/5/6. 3/8m/min 4/1pulley ratio
卷筒直径 Drum Diameter	295mm
电机功率 Motor power	P=2. 4/15. 0-3. 2/19. 2kW (12/2极数) P=2. 4/15. 0-3. 2/19. 2kW (12/2poles)
输出轴EXT Output shaft EXT	EXT W74X2X30X36X6h

产品优势

- 重量轻-运输成本低，装配简单
- 效率高-节能
- 设计紧凑-节省空间
- 轴距长-方便安装
- 动态的加速特性-较大的启动和极限力矩
- 双面安全制动-安全且无振动的制动
- 卷筒轴承支持与升降驱动系统集成设计

Advantages

- Low weight -low shipping cost, simple to install
- Highly efficient-energy saving
- Compact design- space-saving
- Long center distance-mounting friendly
- Dynamic acceleration characteristics-heavier starting and limited torque
- Double side safety brake-safety and vibration free
- Integrated design is applied in drum bearing support and lifting drive system

QZ20000 钢绳葫芦升降驱动系统 QZ20000 Wire Rope Hoist Lifting Drive System

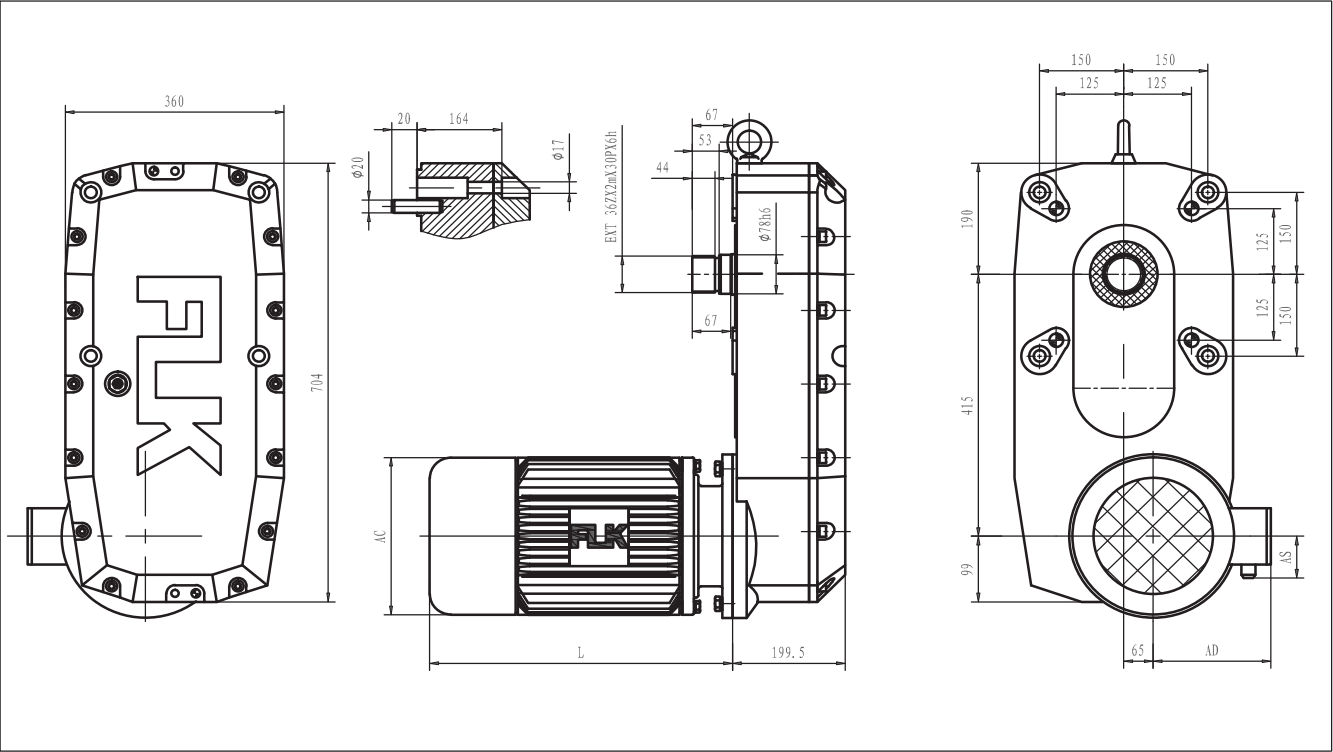

QZ20000 升降驱动系统技术数据							QZ20000 Wire Rope Hoist Lifting Drive System			
卷筒直径 295mm 4/1的滑轮倍率							Drum Diameter 295mm 4/1 pulley ratio			
Pos.	Load [t]	ISO	FEM	V [m/min]	P [kW]	f [Hz]	减速比 Ratio [i]	制动力矩 Brake Torque [N·m]	型号 Type	电机尺寸 Motor Size [mm]
1	16	M5	2m	0.66/4.0 (0.8/4.8)	2.4/15.0 (2.88/18.0)	50 (60)	170.2	150	QZ20000-150-2.4/15.0-12/2	L: 655
	12.5	M6	3m							AC: 279
	10	M7	4m							AD: 210
	8	M7	4m							AS: 75
2	20	M4	1Am	0.66/4.0 (0.8/4.8)	3.2/19.2 (3.84/23.04)	50 (60)	170.2	150	QZ20000-170.2-3.2/19.2-12/2	L: 710
	16	M5	2m							AC: 339
	12.5	M6	3m							AD: 260
	10	M7	4m							AS: 85
3	16	M4	1Am	0.8/5.0 (1.0/6.0)	3.2/19.2 (3.84/23.04)	50 (60)	118.3	150	QZ20000-118.3-3.2/19.2-12/2	L: 710
	12.5	M5	2m							AC: 339
	10	M6	3m							AD: 260
	8	M7	4m							AS: 85
4	12.5	M4	1Am	1.0/6.3 (1.2/7.6)	3.2/19.2 (3.84/23.04)	50 (60)	107.1	150	QZ20000-107.1-3.2/19.2-12/2	L: 710
	10	M5	2m							AC: 339
	8	M6	3m							AD: 260
	6.3	M7	4m							AS: 85
5	10	M4	1Am	1.3/8.0 (1.6/9.6)	3.2/19.2 (3.84/23.04)	50 (60)	82.9	150	QZ20000-82.9-3.2/19.2-12/2	L: 710
	8	M5	2m							AC: 339
	6.3	M6	3m							AD: 260
	5	M7	4m							AS: 85

QZ25000 钢绳葫芦升降驱动系统

QZ25000 Wire Rope Hoist Lifting Drive System

产品描述 Description

- 参照FEM标准设计的结构紧凑的钢绳葫芦升降驱动系统
- 三级平行轴式齿轮减速电机，直接安装于卷筒
- 带双面安全制动器的大功率升降电机
- 通过标准接口装配简单
- Compact construction and in accordance with FEM
- 3 stage Parallel Shaft Geared Motor, directly mounted in hoisting drum
- High power hoisting electric motor with double side safety brake
- Standard connector, simple to install

技术数据 Technical Data

技术数据 Technical Data	
起升重量 Lifting capacity	达到25吨 up to 25T
起升速度 Lifting speed	3. 4/4. 2/5. 4/6. 7m/min 4/1的滑轮倍率 3. 4/4. 2/5. 4/6. 7m/min 4/1pulley ratio
卷筒直径 Drum Diameter	325mm
电机功率 Motor power	P=2. 4/15. 0-3. 2/19. 2kW (12/2极数) P=2. 4/15. 0-3. 2/19. 2kW (12/2poles)
输出轴EXT Output shaft EXT	EXT W90X2X30X44X6h

产品优势

- 重量轻-运输成本低，装配简单
- 效率高-节能
- 设计紧凑-节省空间
- 轴距长-方便安装
- 动态的加速特性-较大的启动和极限力矩
- 双面安全制动-安全且无振动的制动
- 卷筒轴承支持与升降驱动系统集成设计

Advantages

- Low weight -low shipping cost, simple to install
- Highly efficient-energy saving
- Compact design- space-saving
- Long center distance-mounting friendly
- Dynamic acceleration characteristics-heavier starting and limited torque
- Double side safety brake-safety and vibration free
- Integrated design is applied in drum bearing support and lifting drive system

QZ25000 钢绳葫芦升降驱动系统 QZ25000 Wire Rope Hoist Lifting Drive System

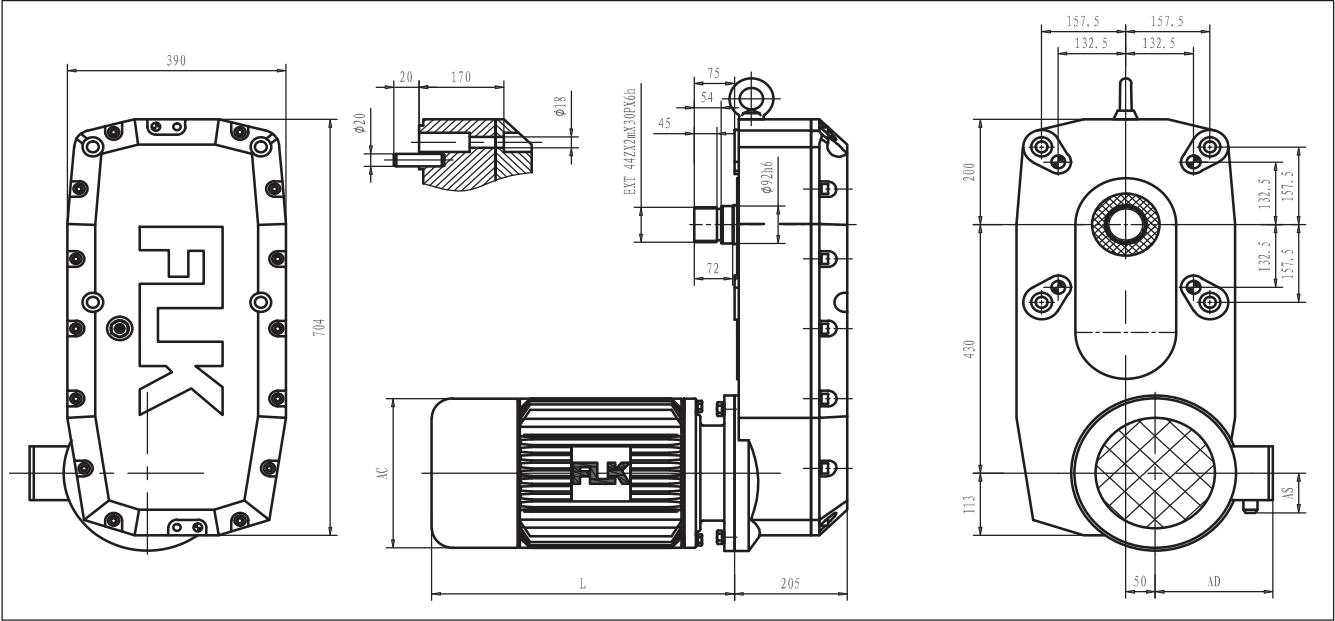

QZ25000 升降驱动系统技术数据										QZ25000 Wire Rope Hoist Lifting Drive System	
卷筒直径 325mm 4/1的滑轮倍率										Drum Diameter 325mm 4/1 pulley ratio	
Pos.	Load [t]	ISO	FEM	V [m/min]	P [kW]	f [Hz]	减速比 Ratio [i]	制动力矩 Brake Torque [N · m]	型号 Type	电机尺寸 Motor Size [mm]	
1	20	M4	1Am	0.53/3.4 (0.63/4.1)	2.4/15.0 (2.88/18.0)	50 (60)	216.6	100	QZ25000-216.6-2.4/15.0-12/2	L:	619
	16	M5	2m							AC:	270
	12.5	M6	3m							AD:	190
	10	M7	4m							AS:	84
2	16	M4	1Am	0.65/4.23 (0.8/5.1)	2.4/15.0 (2.88/18.0)	50 (60)	174.9	100	QZ25000-174.9-2.4/15.0-12/2	L:	619
	12.5	M5	2m							AC:	270
	10	M6	3m							AD:	190
	8	M7	4m							AS:	84
3	12.5	M4	1Am	0.83/5.35 (1.03/6.4)	2.4/15.0 (2.88/18.0)	50 (60)	138.5	100	QZ25000-138.5-2.4/15.0-12/2	L:	619
	10	M5	2m							AC:	270
	8	M6	3m							AD:	190
	6.3	M7	4m							AS:	84
4	10	M4	1Am	1.03/6.7 (1.24/8.1)	2.4/15.0 (2.88/18.0)	50 (60)	110.7	100	QZ25000-110.7-2.4/15.0-12/2	L:	619
	8	M5	2m							AC:	270
	6.3	M6	3m							AD:	190
	5	M7	4m							AS:	84
5	25	M4	1Am	0.53/3.4 (0.63/4.1)	3.2/19.2 (3.84/23.04)	50 (60)	216.6	150	QZ25000-216.6-3.2/19.2-12/2	L:	666
	20	M5	2m							AC:	313
	16	M6	3m							AD:	234.5
	12.5	M7	4m							AS:	84
6	20	M4	1Am	0.65/4.23 (0.8/5.1)	3.2/19.2 (3.84/23.04)	50 (60)	174.9	150	QZ25000-174.9-3.2/19.2-12/2	L:	666
	16	M5	2m							AC:	313
	12.5	M6	3m							AD:	234.5
	10	M7	4m							AS:	84
7	16	M4	1Am	0.83/5.35 (1.03/6.4)	3.2/19.2 (3.84/23.04)	50 (60)	138.5	150	QZ25000-138.5-3.2/19.2-12/2	L:	666
	12.5	M5	2m							AC:	313
	10	M6	3m							AD:	234.5
	8	M7	4m							AS:	84
8	12.5	M4	1Am	1.03/6.7 (1.24/8.1)	3.2/19.2 (3.84/23.04)	50 (60)	110.7	150	QZ25000-110.7-3.2/19.2-12/2	L:	666
	10	M5	2m							AC:	313
	8	M6	3m							AD:	234.5
	6.3	M7	4m							AS:	84

QZ40000 钢绳葫芦升降驱动系统

QZ40000 Wire Rope Hoist Lifting Drive System

产品描述 Description

- 参照FEM标准设计的结构紧凑的钢绳葫芦升降驱动系统
- 三级平行轴式齿轮减速电机，直接安装于卷筒
- 带双面安全制动器的大功率升降电机
- 通过标准接口装配简单
- Compact construction and in accordance with FEM
- 3 stage Parallel Shaft Geared Motor, directly mounted in hoisting drum
- High power hoisting electric motor with double side safety brake
- Standard connector, simple to install

技术数据 Technical Data

技术数据 Technical Data	
起升重量 Lifting capacity	达到40吨 up to 40T
起升速度 Lifting speed	2.6/3.3/4.2/8m/min 4/1的滑轮倍率 2.6/3.3/4.2/8m/min 4/1pulley ratio
卷筒直径 Drum Diameter	405mm
电机功率 Motor power	P=6.0/24.2kW (8/2极数) P=6.0/24.2kW (8/2poles)
输出轴EXT Output shaft EXT	EXT W110X2X30X54X6h

产品优势

- 重量轻-运输成本低，装配简单
- 效率高-节能
- 设计紧凑-节省空间
- 轴距长-方便安装
- 动态的加速特性-较大的启动和极限力矩
- 双面安全制动-安全且无振动的制动
- 卷筒轴承支持与升降驱动系统集成设计

Advantages

- Low weight -low shipping cost, simple to install
- Highly efficient-energy saving
- Compact design- space-saving
- Long center distance-mounting friendly
- Dynamic acceleration characteristics-heavier starting and limited torque
- Double side safety brake-safety and vibration free
- Integrated design is applied in drum bearing support and lifting drive system

QZ40000 钢绳葫芦升降驱动系统 QZ40000 Wire Rope Hoist Lifting Drive System

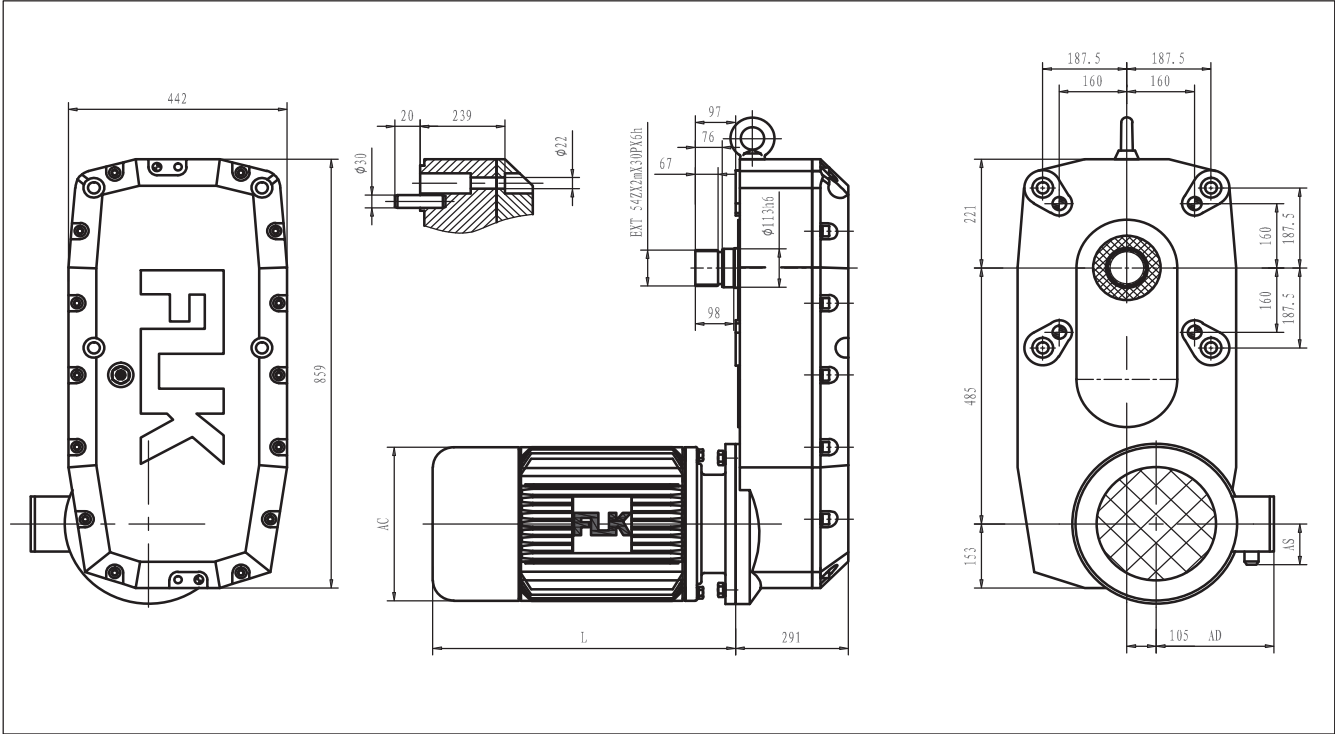

QZ40000 升降驱动系统技术数据

卷筒直径 405mm 4/1的滑轮倍率

QZ40000 Wire Rope Hoist Lifting Drive System

Drum Diameter405mm 4/1pulley ratio

Pos.	Load [t]	ISO	FEM	V [m/min]	P [kW]	f [Hz]	减 速 比 Ratio [i]	制动力矩 Brake Torque [N · m]	型 号 Type	电机尺寸 Motor Size [mm]
1	40	M5	2m	0.6/2.6 (0.8/3.2)	6.0/24.2 (7.2/29.04)	50 (60)	232	150	QZ40000-232-6.0/24.2-8/2	L: 725
	32	M6	3m							AC: 313
	25	M7	4m							AD: 234
	20	M7	4m							AS: 84
2	32	M5	2m	0.8/3.3 (1.0/4.0)	6.0/24.2 (7.2/29.04)	50 (60)	182.6	150	QZ40000-182.6-6.0/24.2-8/2	L: 725
	25	M6	3m							AC: 313
	20	M7	4m							AD: 234
	16	M7	4m							AS: 84
3	25	M5	2m	1.0/4.2 (1.3/5.1)	6.0/24.2 (7.2/29.04)	50 (60)	144	150	QZ40000-144-6.0/24.2-8/2	L: 725
	20	M6	3m							AC: 313
	16	M7	4m							AD: 234
	12.5	M7	4m							AS: 84

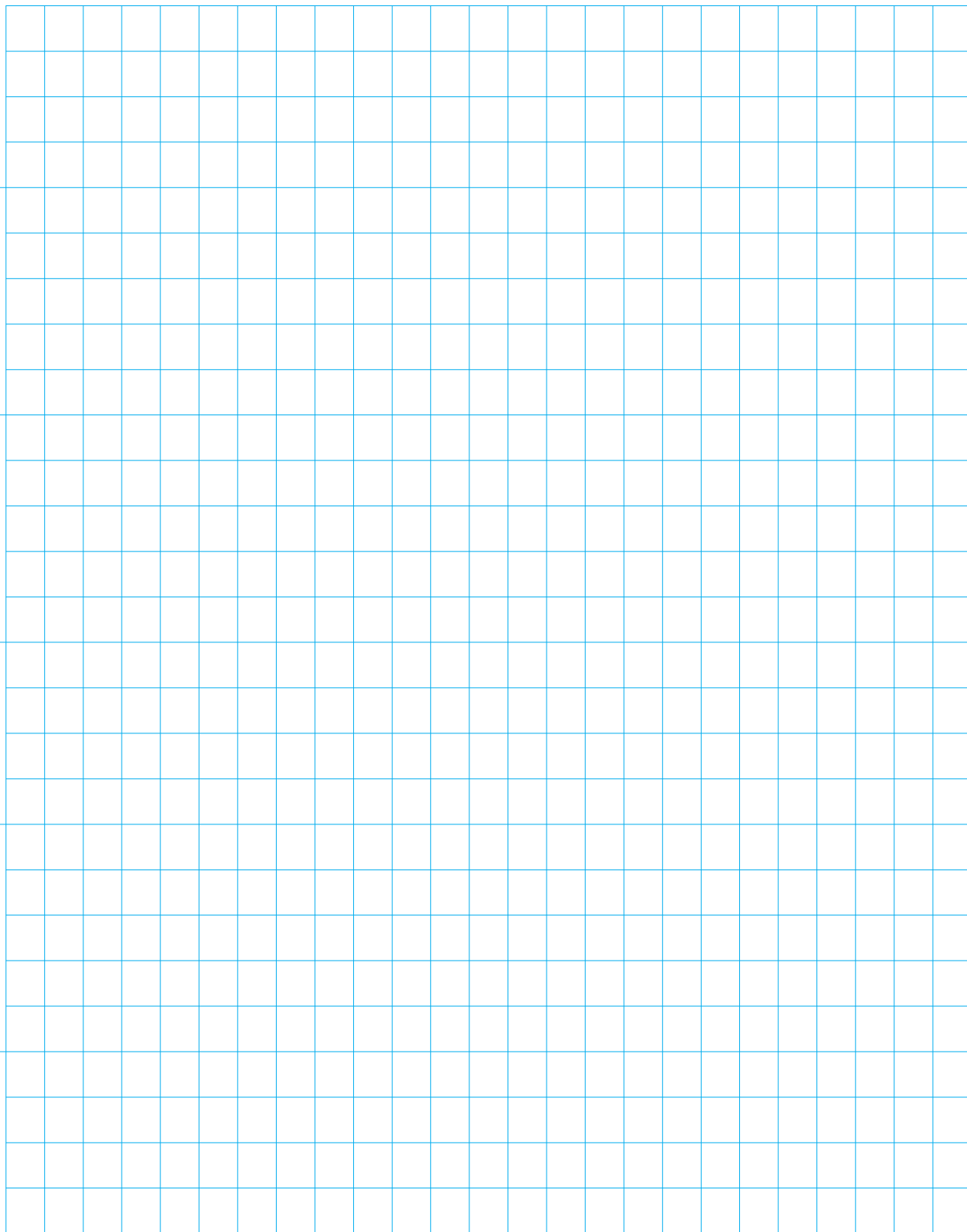

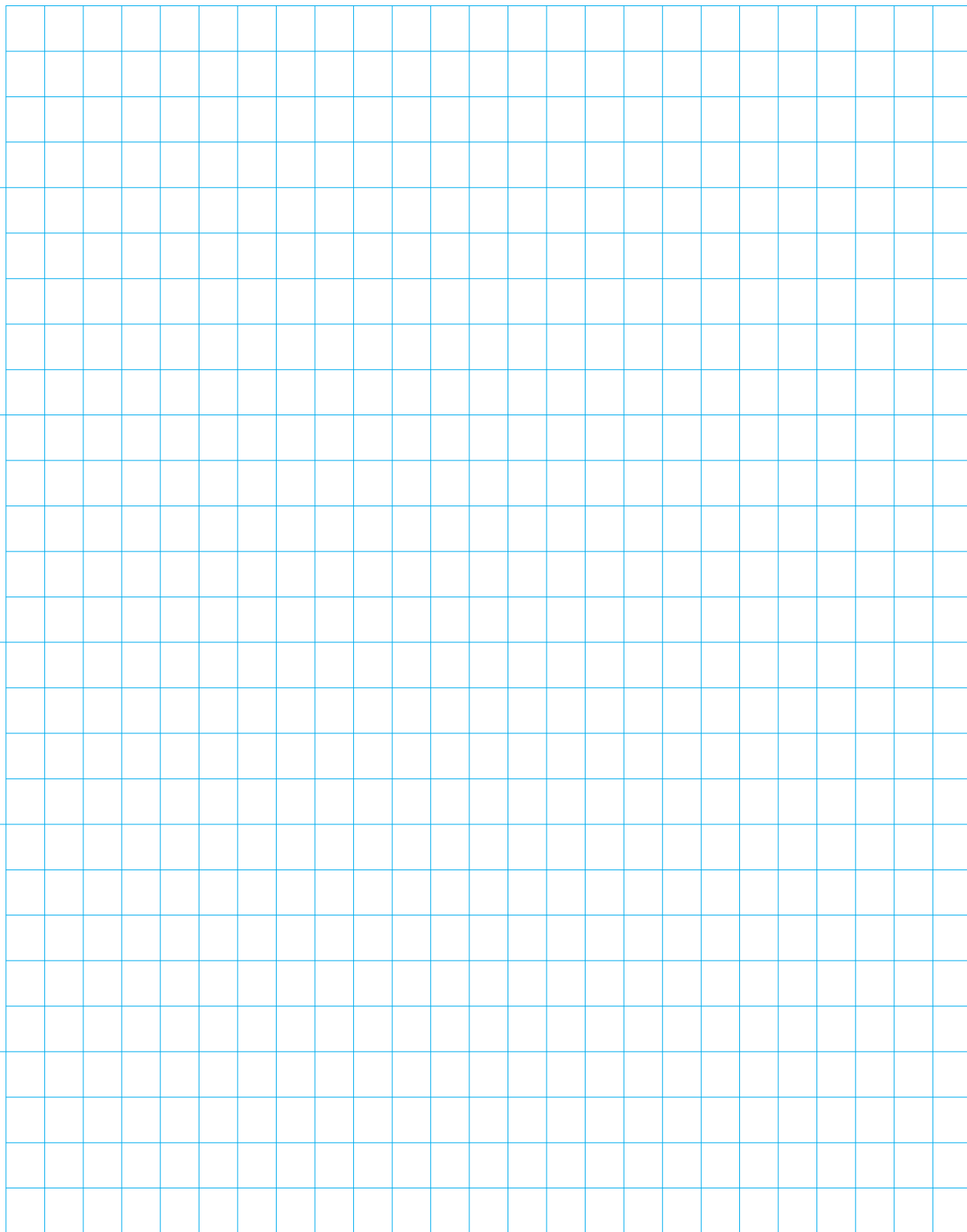



上海费洛卡重工机械有限公司

地址：上海市松江区荣乐西路**266-77**号
生产基地：安徽省六安市经济技术开发区寿春路皋陶路
电话：**021-60706390**
传真：**021-60706393**
邮编：**201617**
E-mail: info@ferrocar.cn
网址：www.ferrocar.cn

Shanghai Ferrocar Machinery Manufacture Co., Ltd.

ADD: No. 266-77, Rongle West Road,
Songjiang Area, Shanghai, China
Production Base: Gaoyao Road, Shouchun Road, Lu'an National
Economic Development Zone, Anhui Province
Tel: 021-60706390
Fax: 021-60706393
Zip: 201617
E-mail: info@ferrocar.cn
Website: www.ferrocar.cn



● 本资料中产品数据仅供参考，若数据有改动，恕不另行通知；图像与实样不符合时，请以实样为准；本公司保留最终解释权。
Product data in the document is only for reference, with no further notice about the change therein. Where the image does not coincide with the sample, the sample shall prevail.
The right of interpretation rests with the company.